

## Asset #10066

### **Building Details:**

State Seal: Florida  
Occupancy: Business  
Type of Construction: VI  
Wind Speed: 110 mph  
Code in Effect at time of manufacture: 1997 SBC

### **Exterior Details:**

Siding: .019 Aluminum  
Roofing Material: .045EPDM  
Frame: Outrigger  
Doors: Aluminum Hollow Core  
Windows: 24" x 54" V/S  
HVAC: Wall Hung  
Mansard: None

### **Interior Details:**

Wall Finish: Woodgrain Paneling  
Floor Finish: Vinyl Composition Floor Tile  
Doors: Hollow Core  
Ceiling: Prefinished Gypsum  
Floor Decking: Single 5/8"



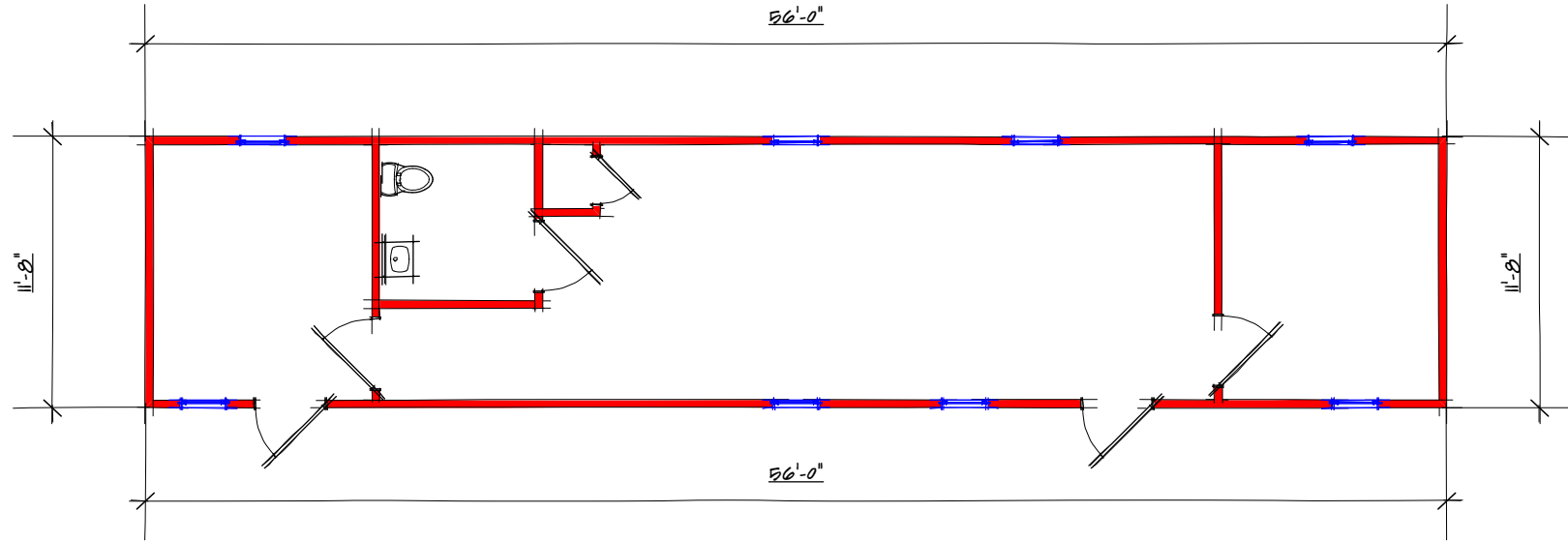

Floor Plan

Asset #10066

**Affordable Structures**  
 235 Apollo Beach Blvd #124  
 Apollo Beach FL 33572  
 813-630-4222 Phone  
 813-651-3394 Fax

# Modular Office Building

Florida DCA Approved

11'-8" x 56'-0"  
 FBC Coded

Copyright 2012: The information contained herein is proprietary and is the exclusive property of Affordable Structures Incorporated. Any reproduction or distribution is strictly prohibited without the express written consent of Affordable Structures Incorporated.

Scale: graphic Plan No: 10066

REV: 3-27-13

# ASI INF