



GENERAL BUILDING INFORMATION:

DRAWING NUMBER: SUD-645-2464  
BUILDING SIZE: 23'-4" x 64'-0"  
SQUARE FOOTAGE: 1,494  
BUILDING USE: EDUCATIONAL

[www.affordablestructures.com](http://www.affordablestructures.com)  
877-739-9120

GENERAL CODE INFORMATION:

- THE MINIMUM AND MAXIMUM NUMBER OF WINDOWS AND DOORS SHALL BE LIMITED. CONSIDERATION MAY BE TAKEN TO THE CODE REQUIREMENTS FOR EGRESS AND ENERGY CONSERVATION.
- REQUIRED PLUMBING FIXTURES ARE SUBJECT TO THE ADOPTED PLUMBING CODE. CONSIDERATION MAY BE TAKEN FOR EXISTING RESTROOMS ON SITE.
- THE BUILDING SQUARE FOOTAGE SHALL BE LIMITED TO THE REQUIREMENTS OF THE ADOPTED BUILDING CODE.
- THE BUILDING SHALL BE SET WITH A PERMANENT OR TEMPORARY FOUNDATION SYSTEM AND APPROVED BY THE LOCAL OFFICIAL HAVING JURISDICTION.
- THE FINAL LAYOUT IS SUBJECT TO REVIEW FOR COMPLIANCE WITH THE BUILDING CODE ENFORCED IN THE AREA THE BUILDING WILL BE LOCATED.
- COPYRIGHT 2016: THE INFORMATION CONTAINED HEREIN IS PROPRIETARY AND IS THE EXCLUSIVE PROPERTY OF AFFORDABLE STRUCTURES INCORPORATED. ANY REPRODUCTION OR DISTRIBUTION IS STRICTLY PROHIBITED WITHOUT THE EXPRESS WRITTEN CONSENT OF AFFORDABLE STRUCTURES INCORPORATED.

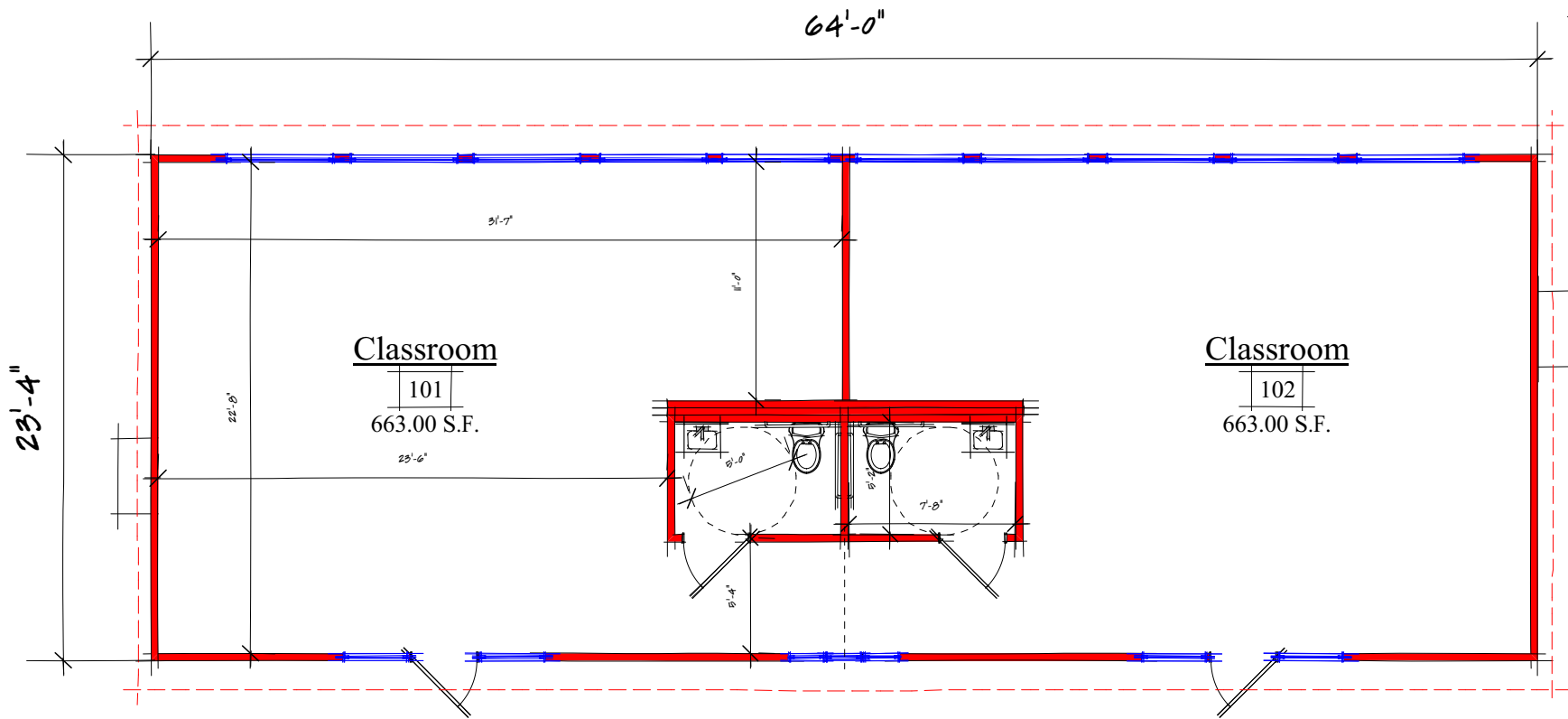
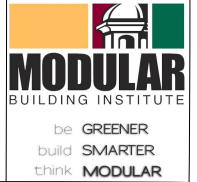

Floor Plan

